

experimentelle Architektur

Realisierungen an der Hochschule Biberach

durchgeführt vom Institut für Konstruktion und
Bautechnologie

unter der Leitung von Prof. Matthias Loebermann



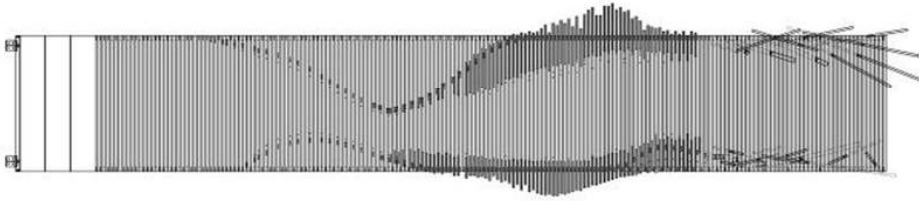
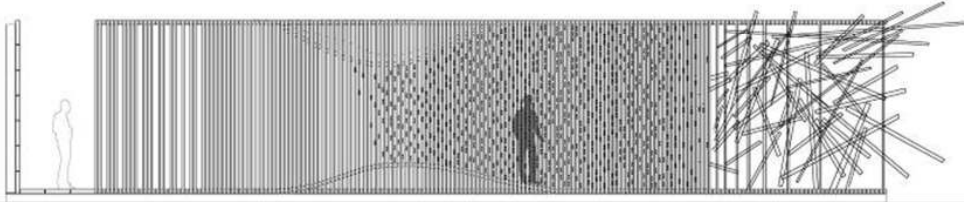
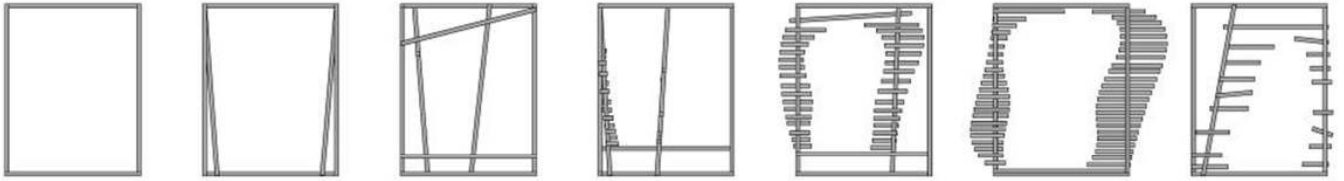







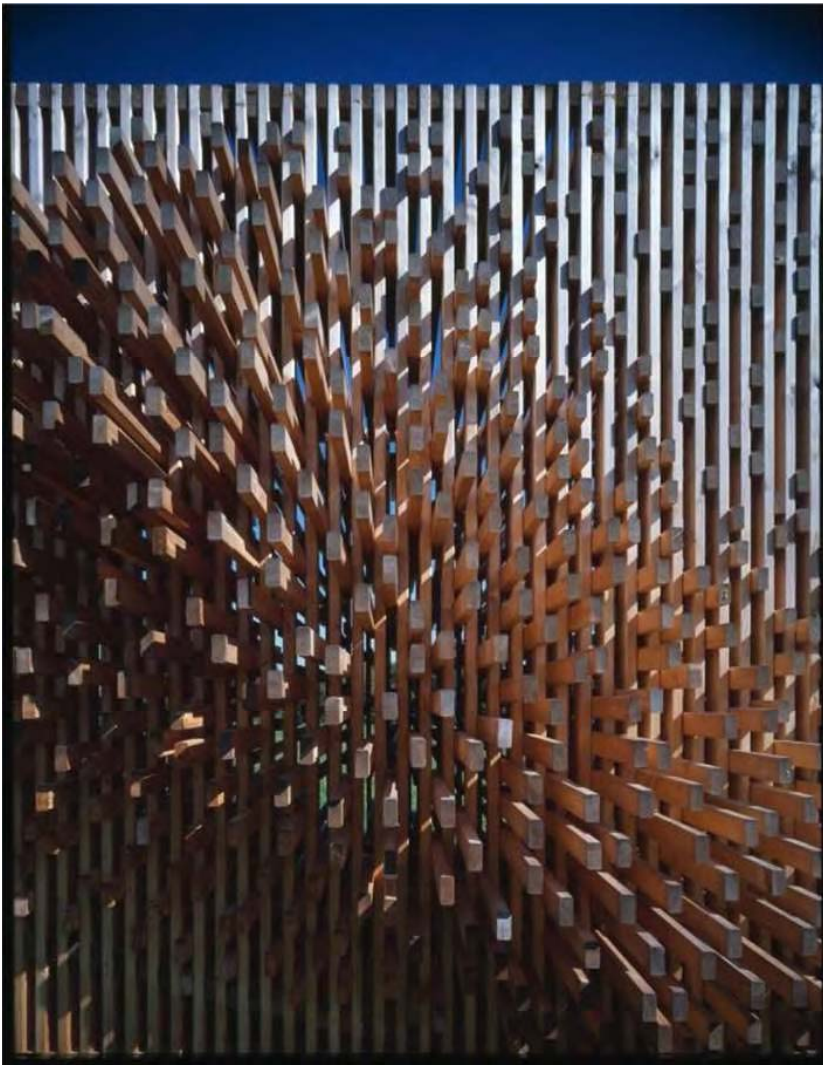

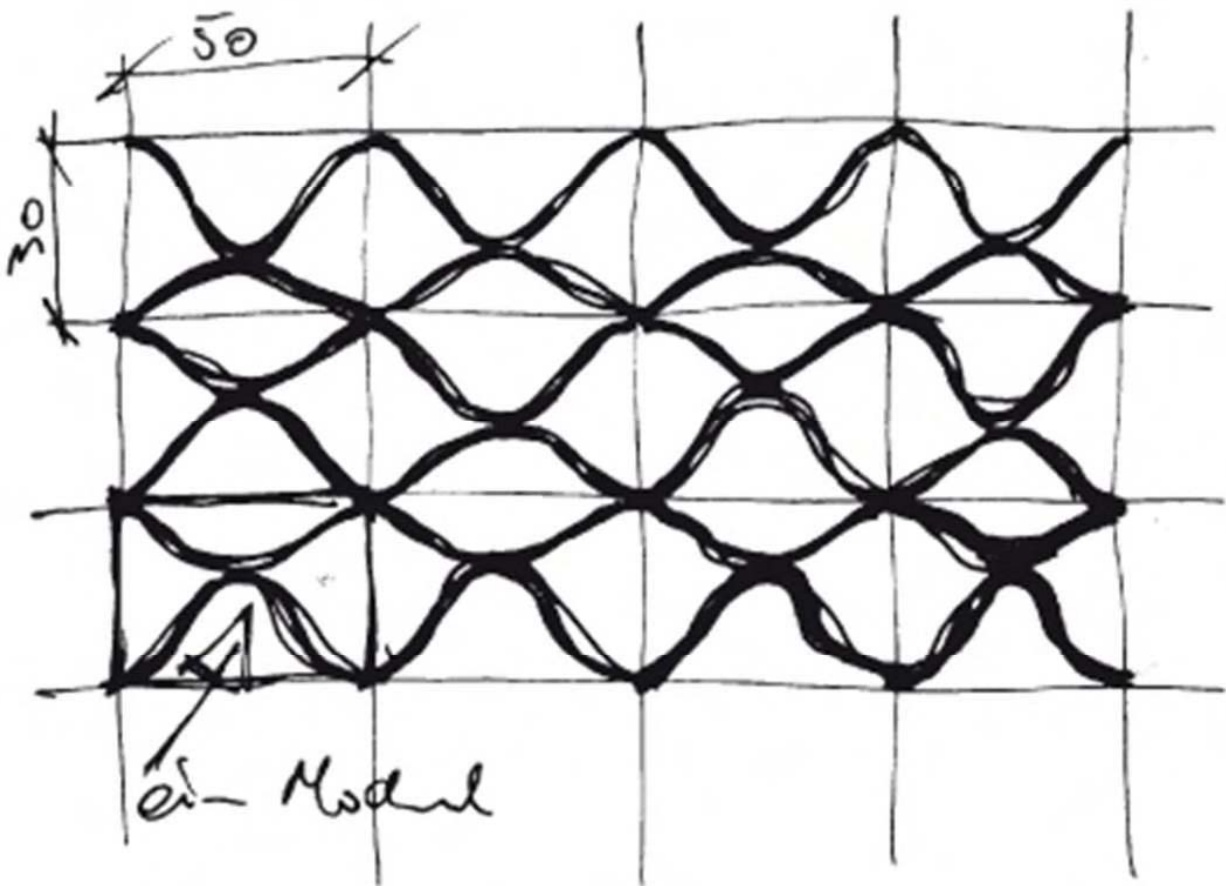
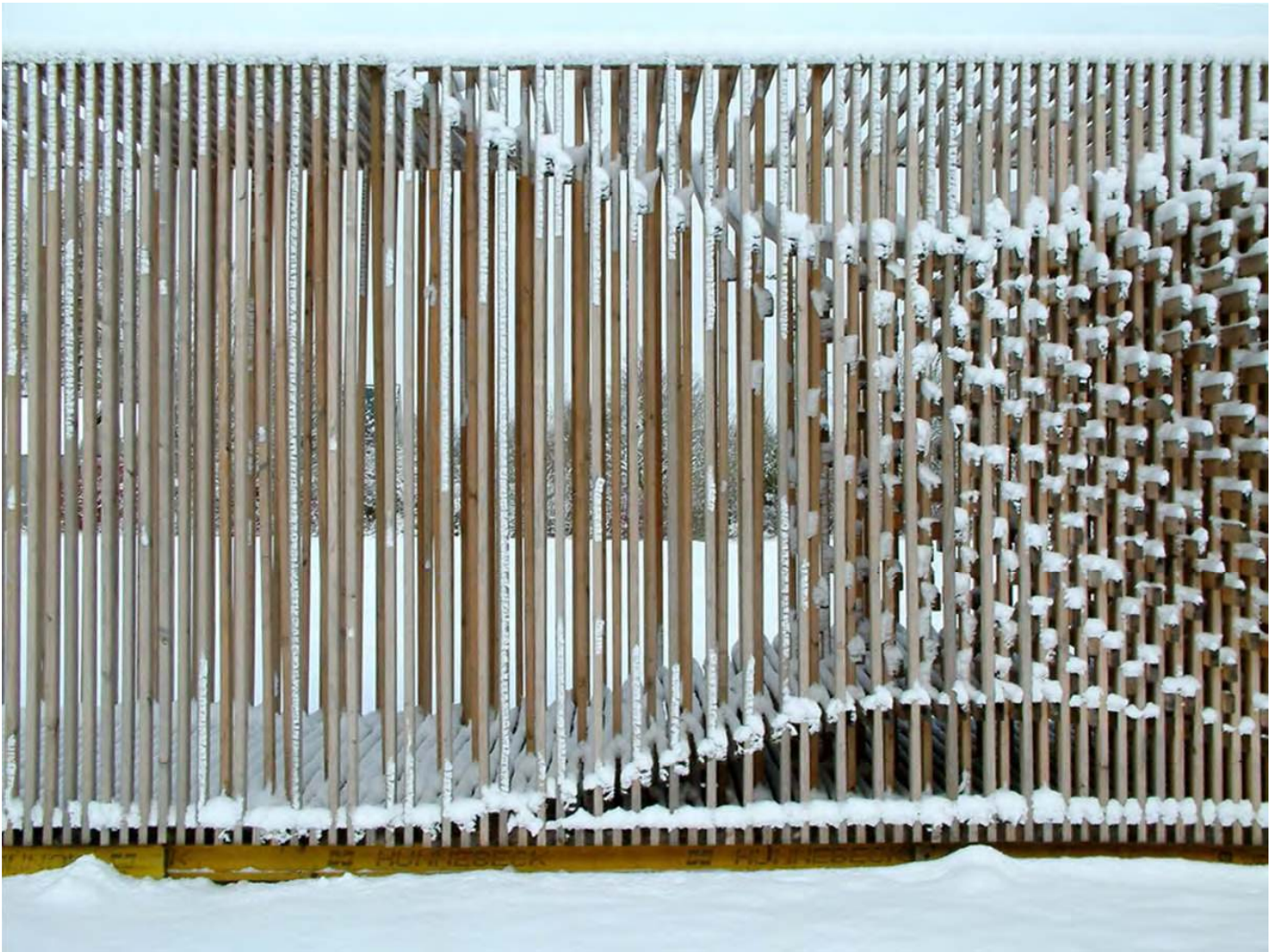

x-modul, bauelemente aus hochfestem , selbstverdichtendem Beton

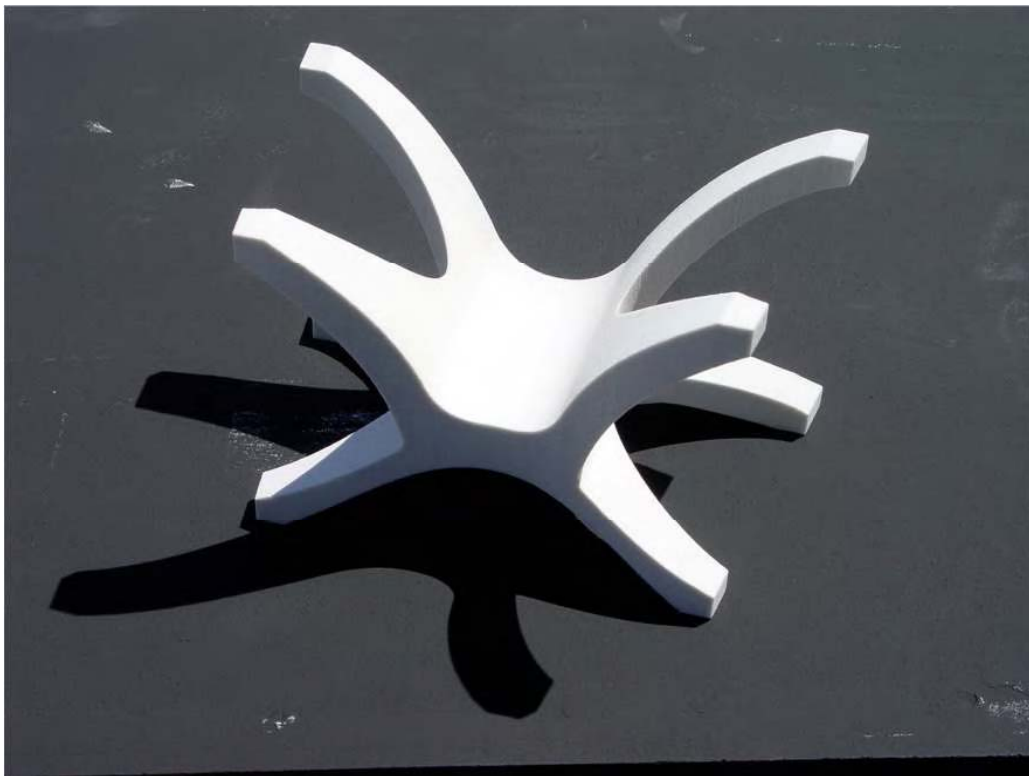
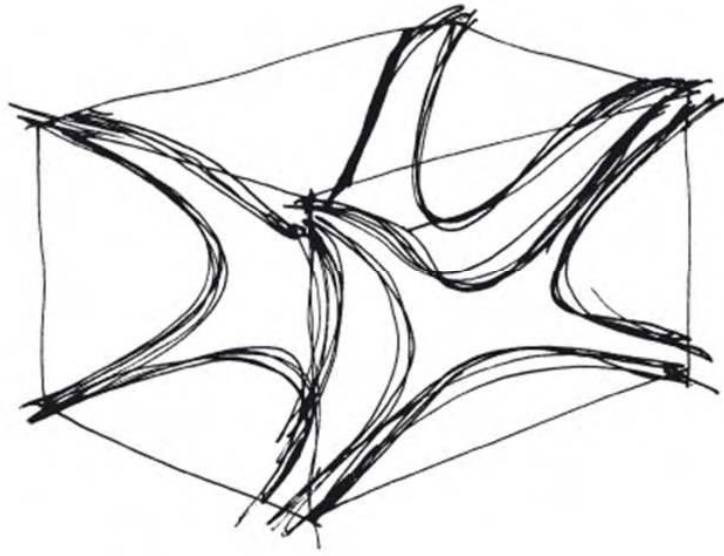



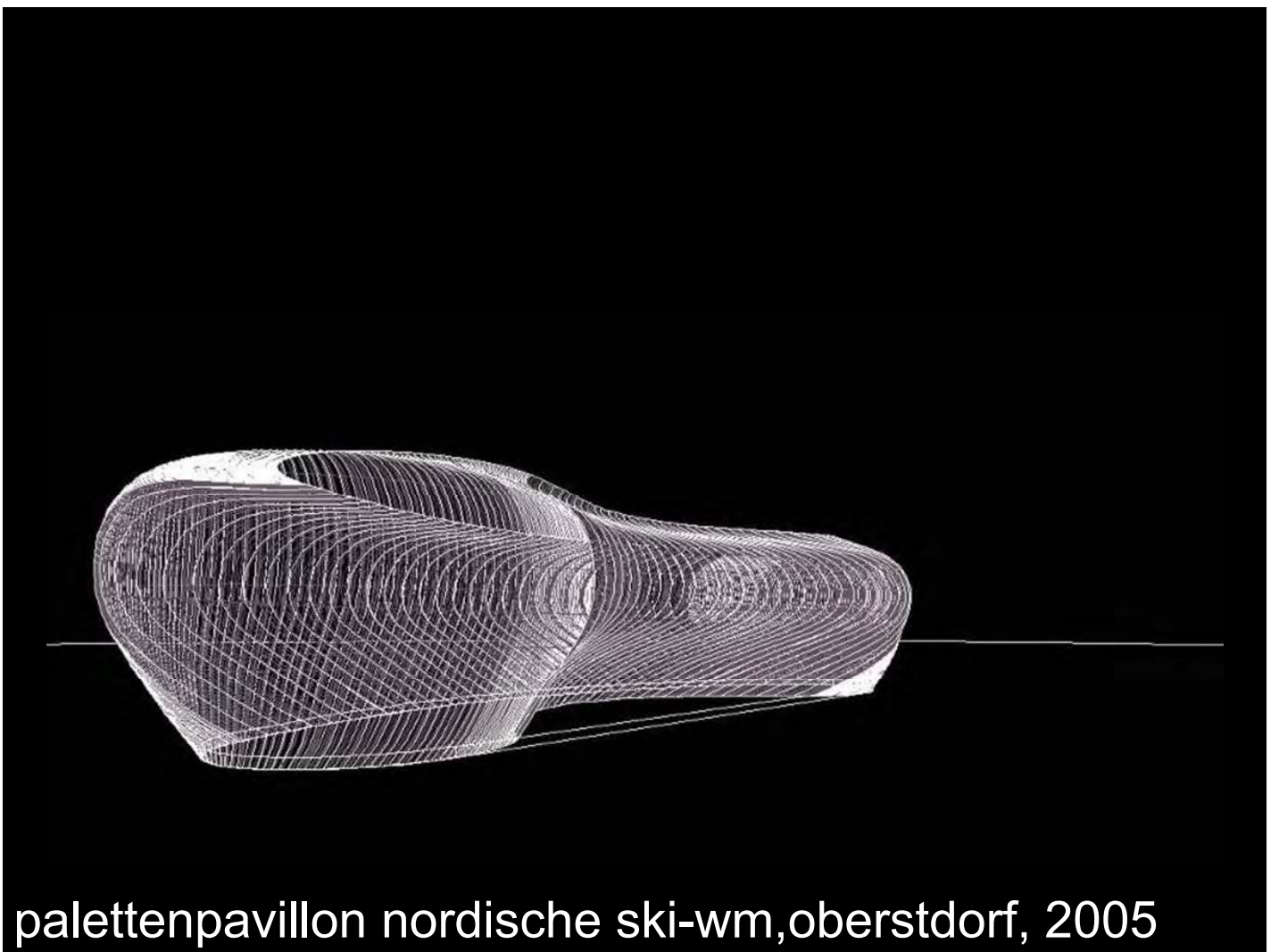
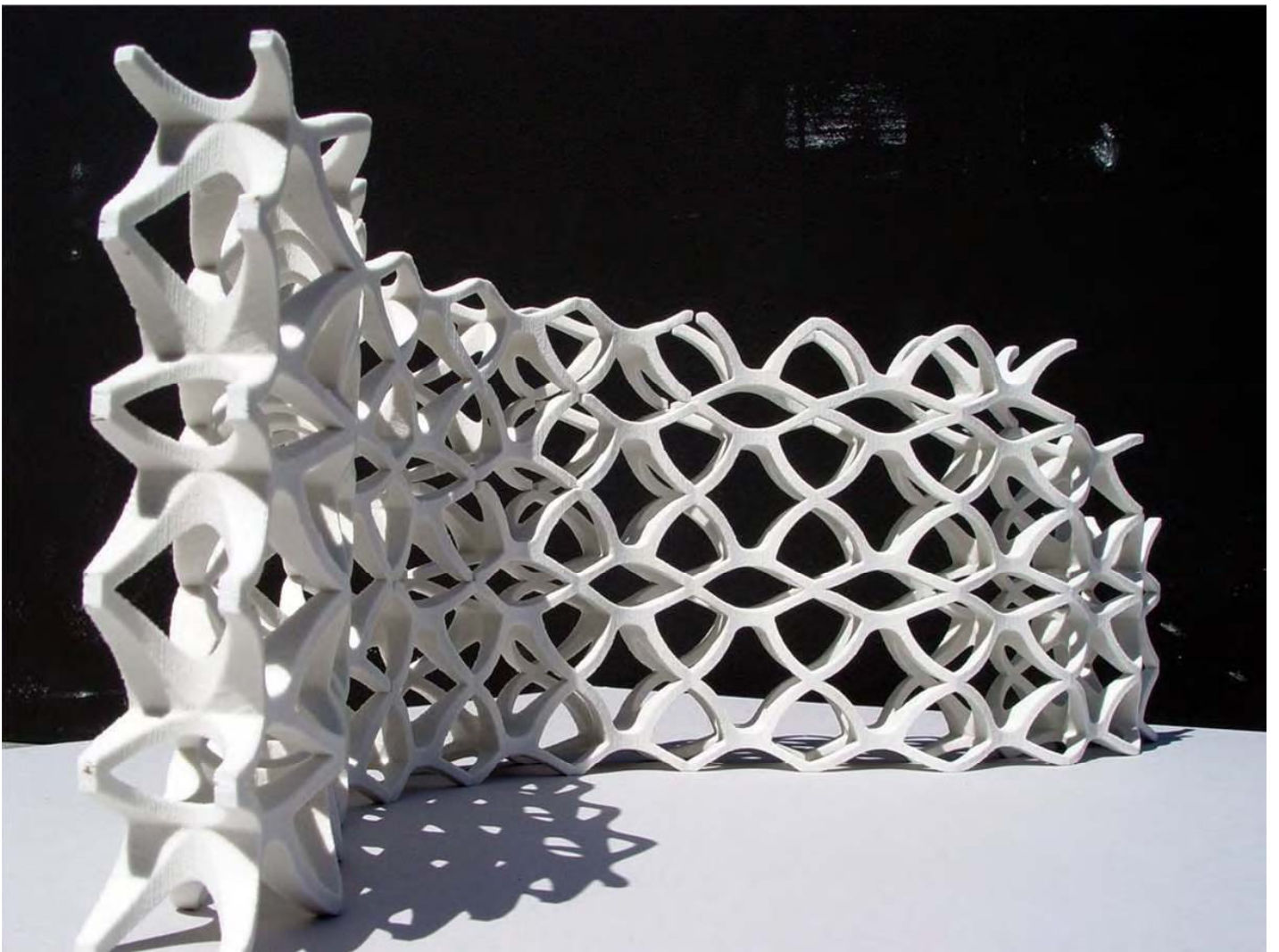

palettenpavillon nordische ski-wm, oberstdorf, 2005





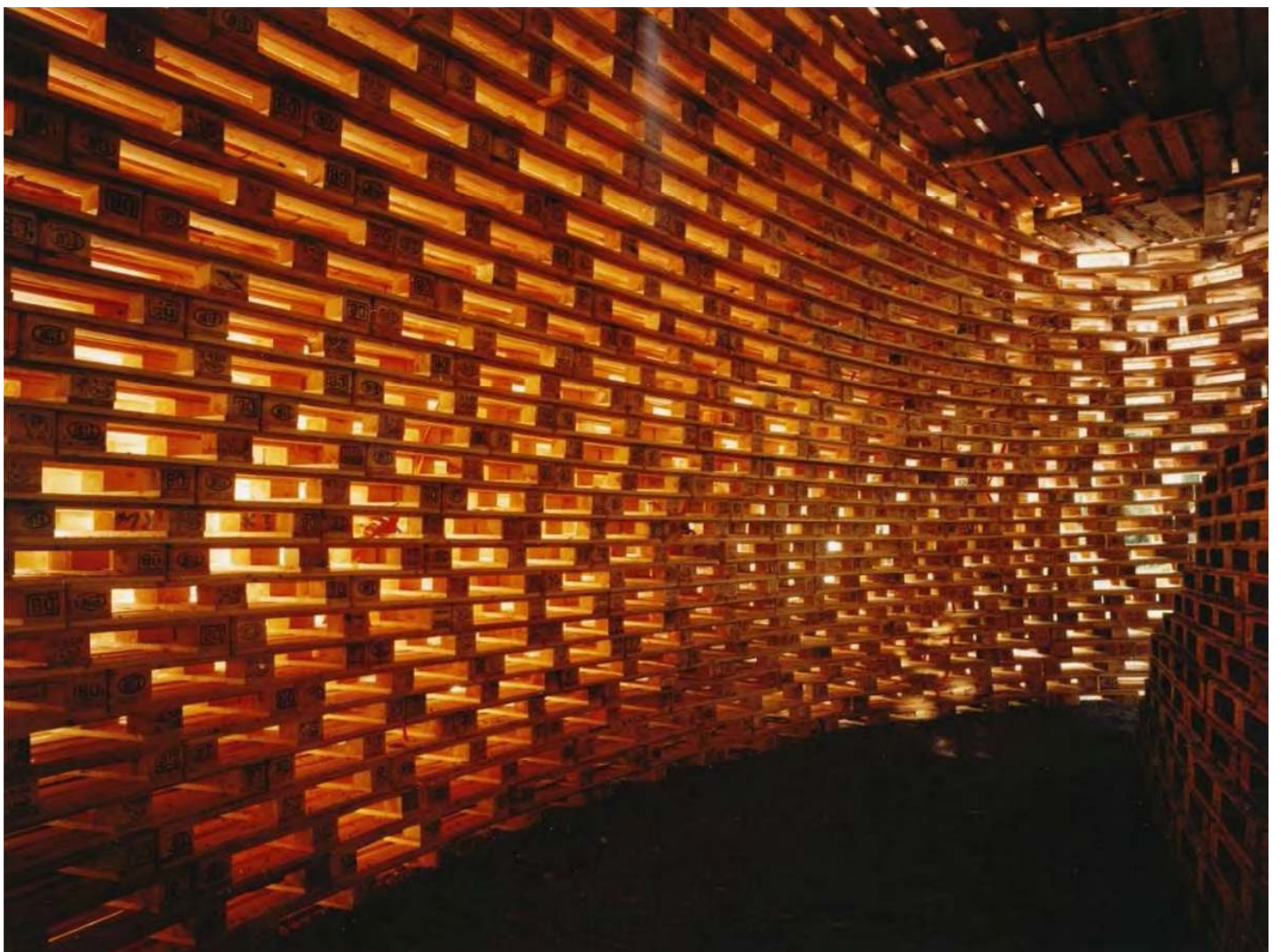
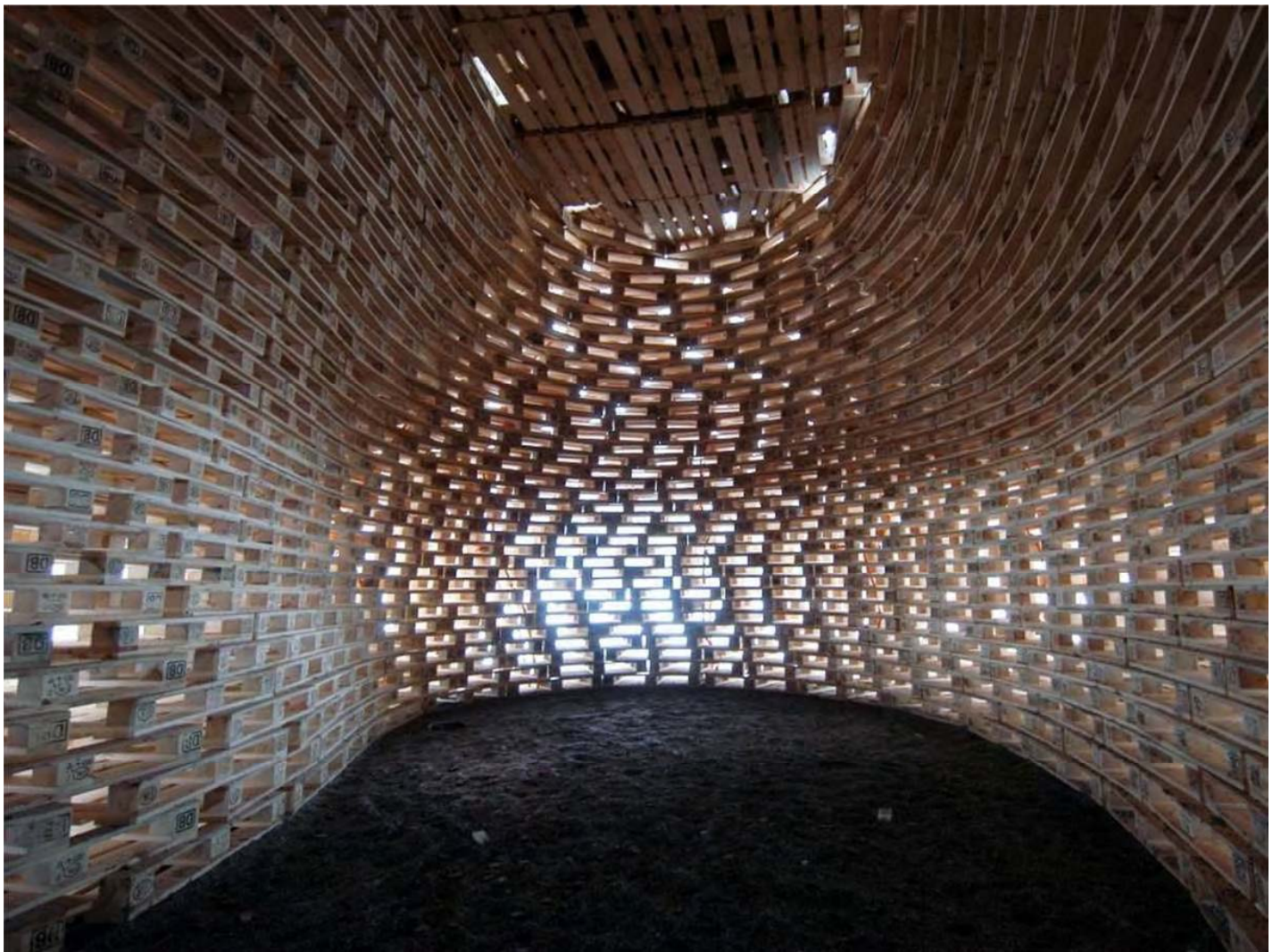

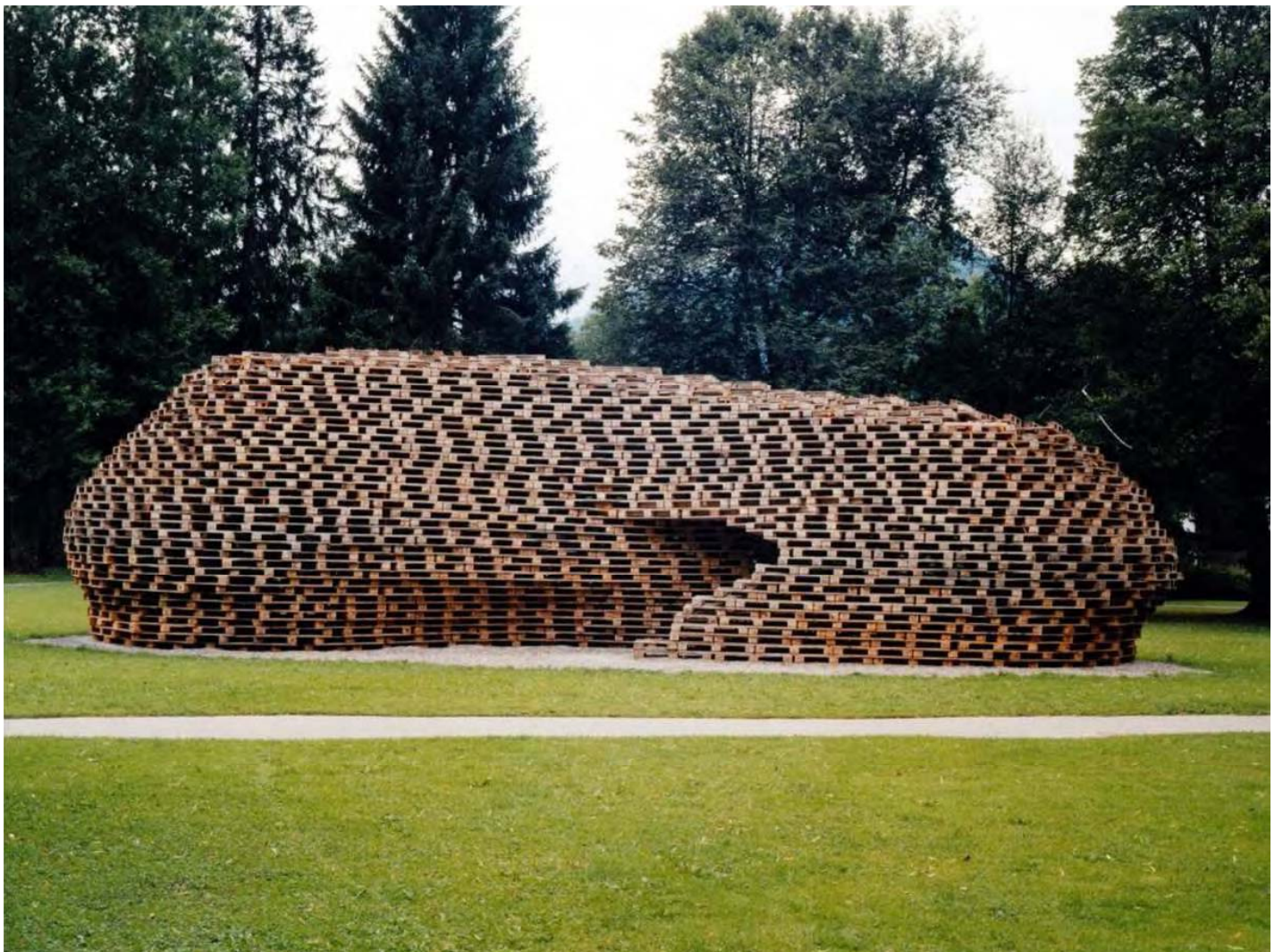



Raum 27 Experimentelles Wohnen auf 3x3x3m, Landesgartenschau Neu-Ulm 2009

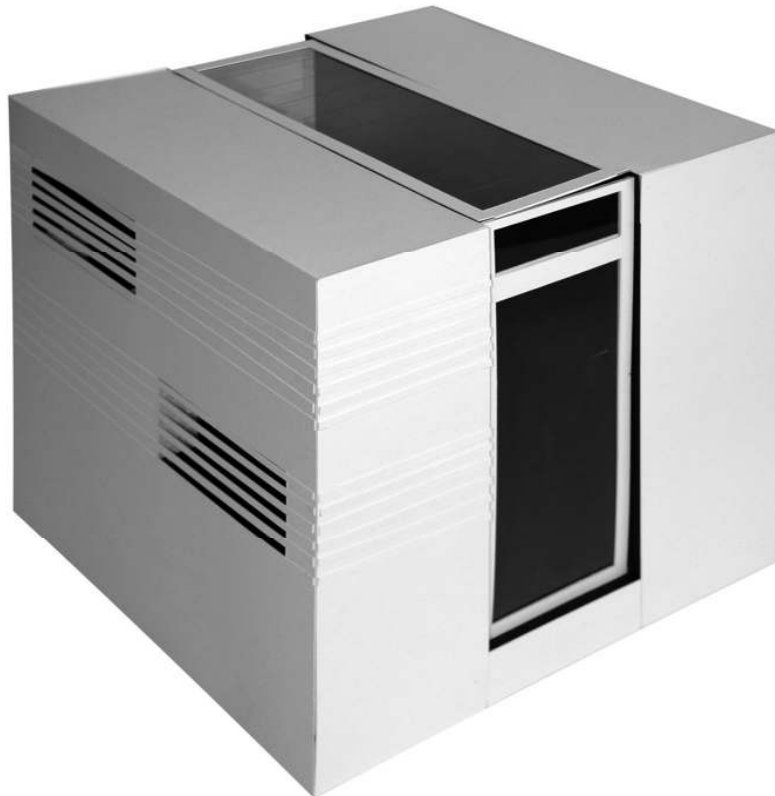
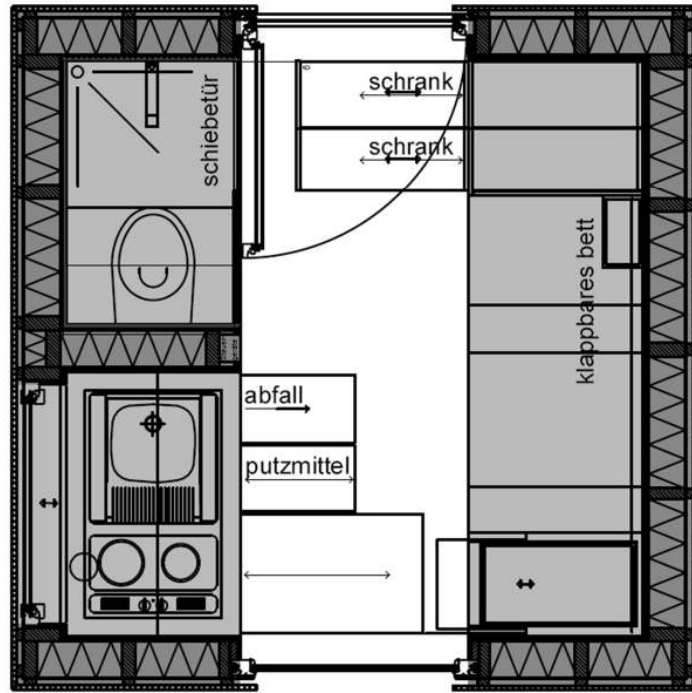

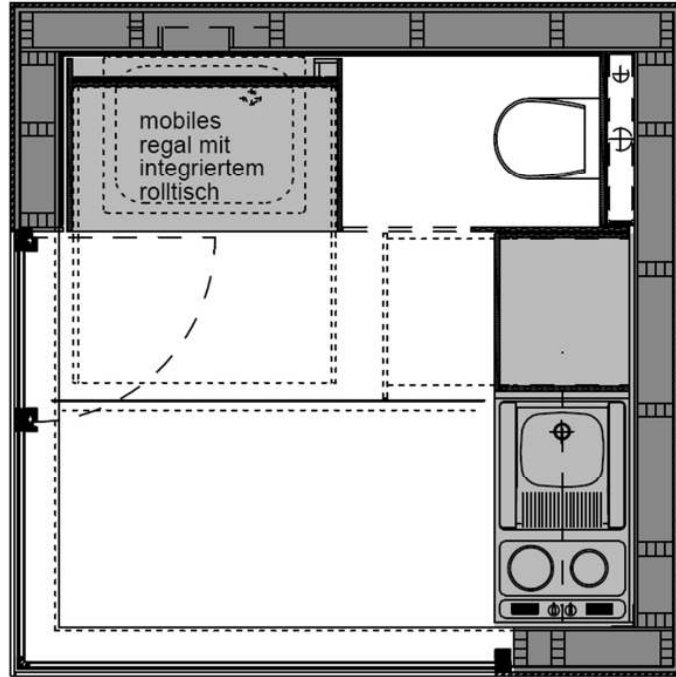

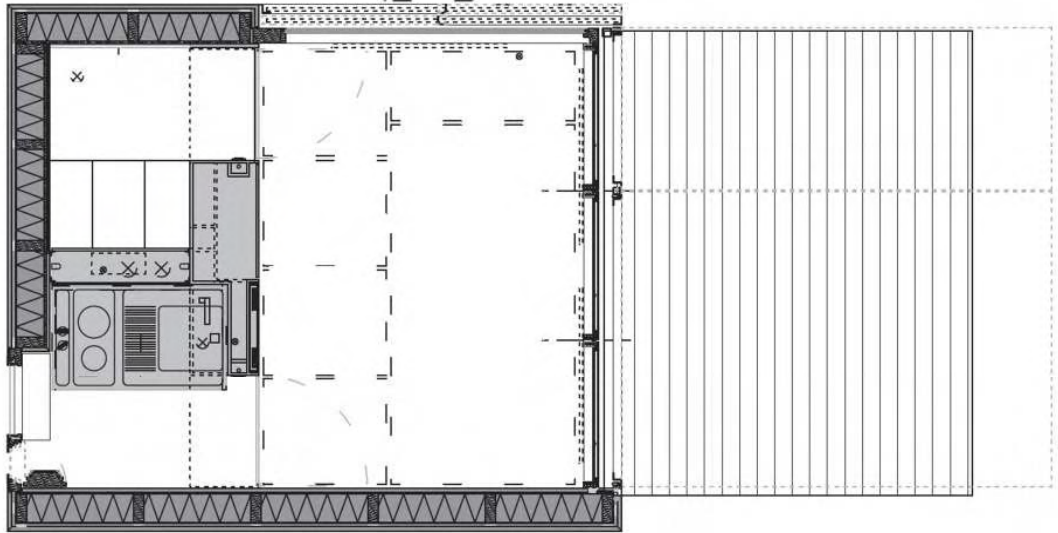





sinneswelt, raum aus papier, 2007

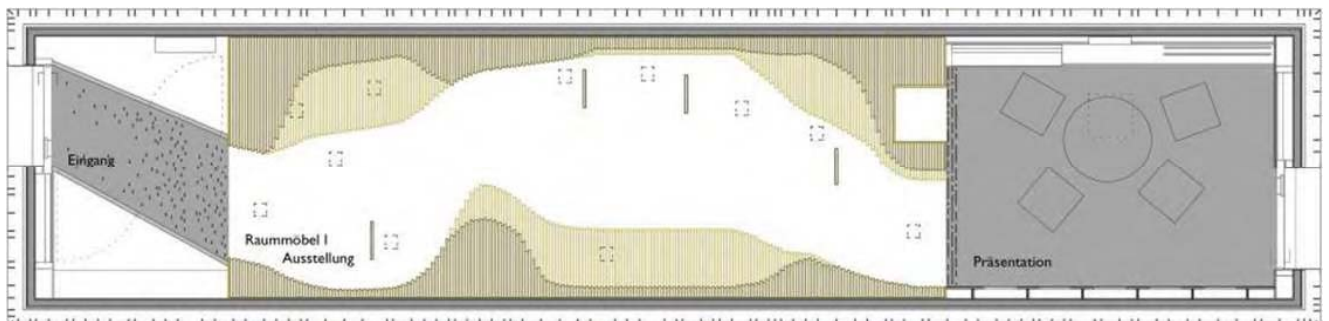

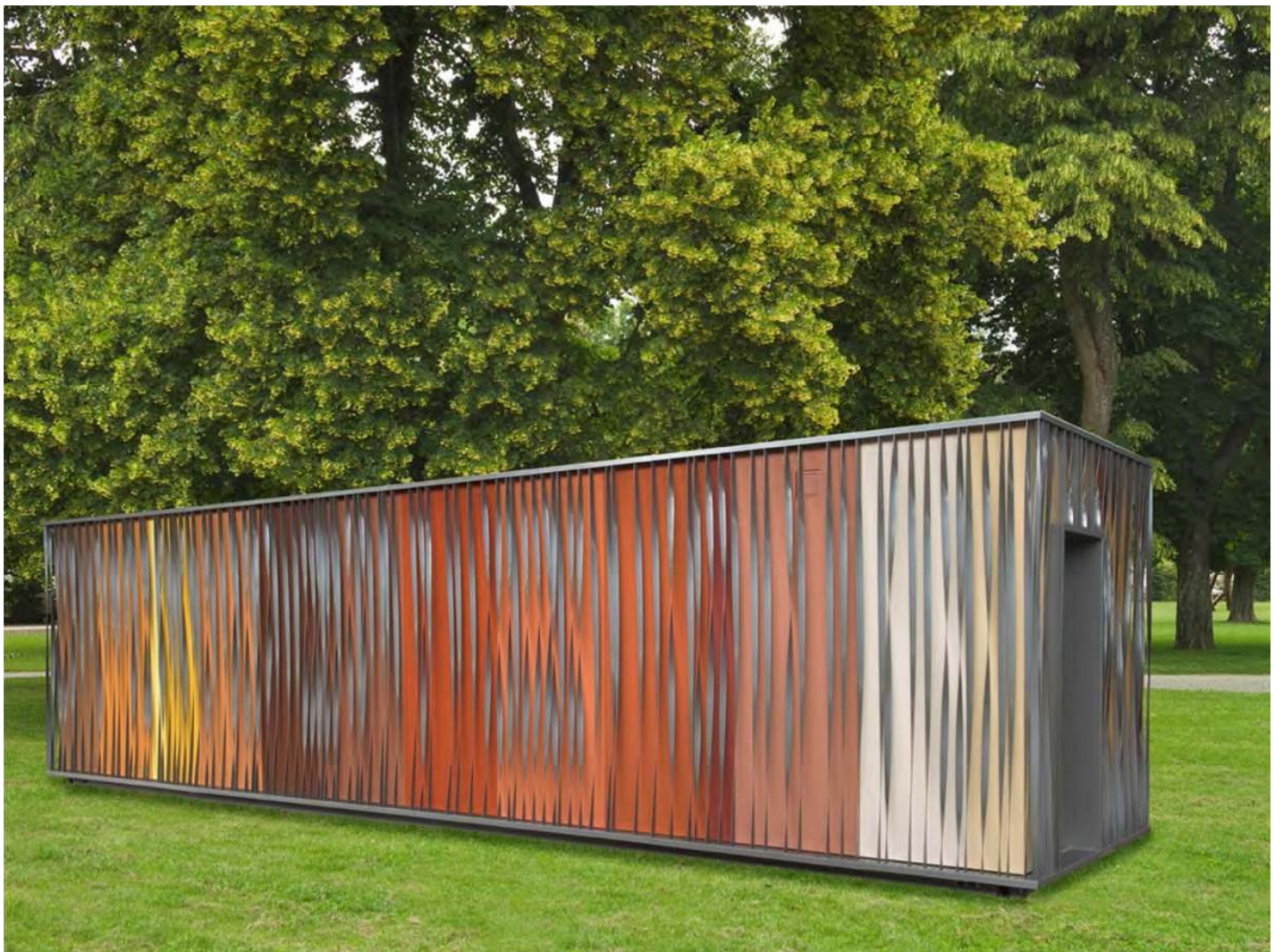
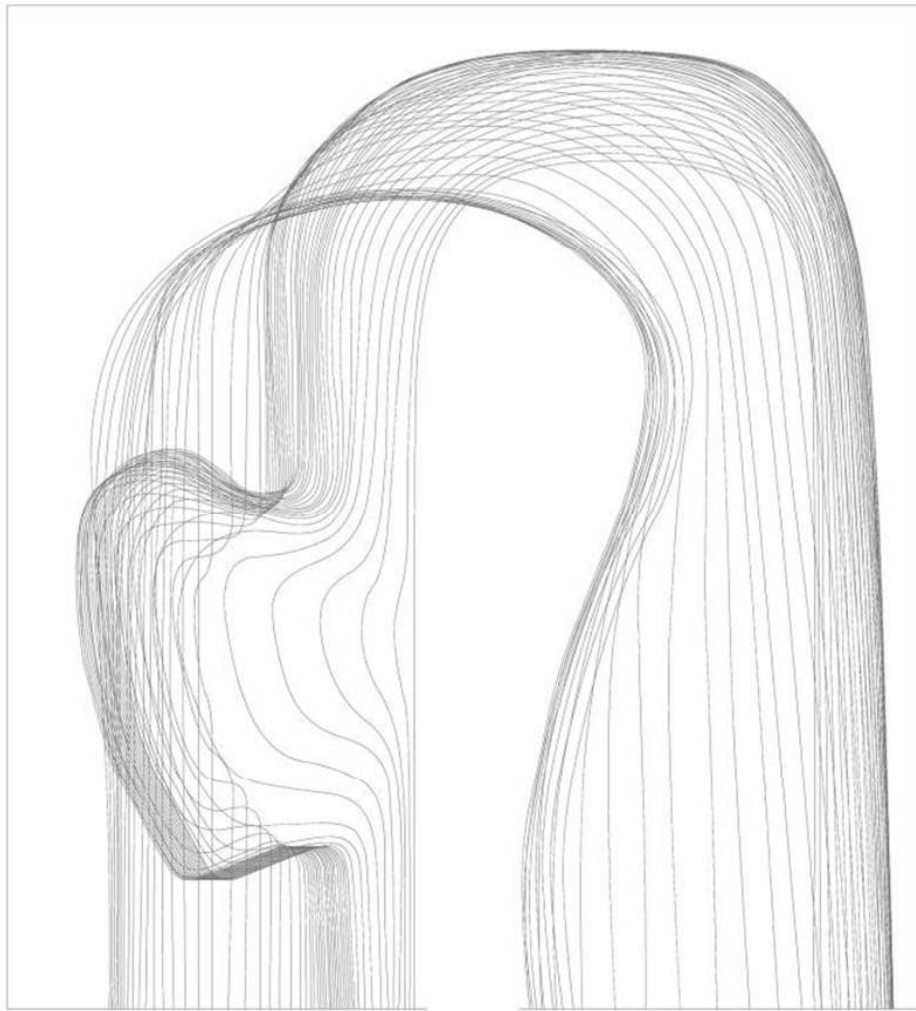

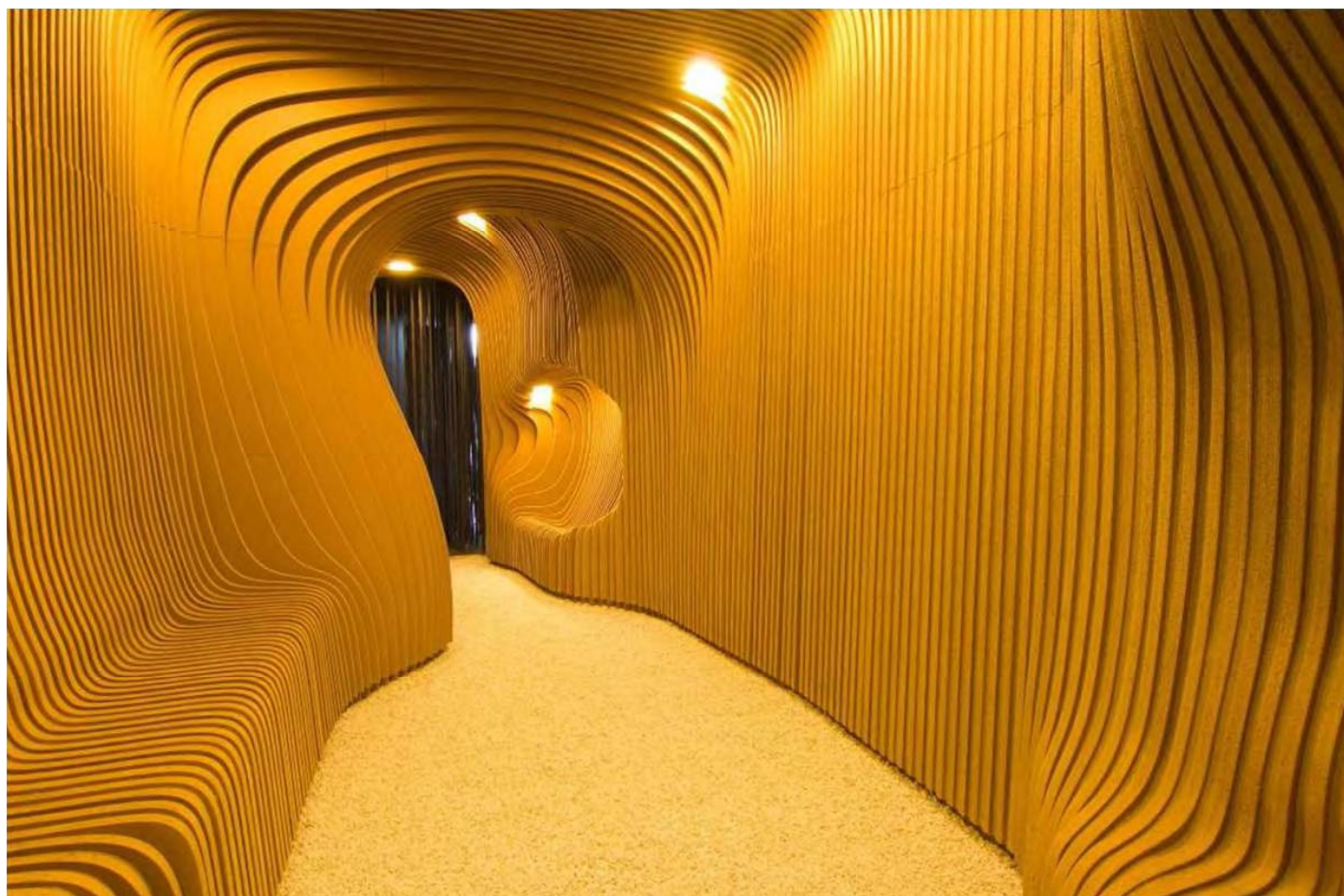



Alpine Ski-WM-Pavillon 2011 , Garmisch-Partenkirchen

